

DISCOVER THE ART OF PRIVACY, OWN YOUR HIDDEN HAVEN THE PANO PHUKET



**NEWLY RELEASED VILLAS
WITH SPECIAL OFFERS**

All texts and simulated images in this picture are for advertising purposes only.
The company reserves the right to make any changes to the advertised details without prior notice.

p
THE PANO
BAAN SUAN LOCH PALM

THE PANO

BAAN SUAN LOCH PALM

“EXPERIENCE UNRIVALED LUXURY LIVING IN A PRIVATE POOL VILLA AMIDST ENCHANTING NATURAL SURROUNDINGS THAT GREET YOU AT HOME”



The Pano Phuket, located in the tranquil Kathu District, offers a serene, low-density living environment ideal for residents seeking premium lifestyles. Developed by MBK Groups with over 20 years of expertise in Phuket, this Modern Tropical project embodies The Art of Privacy Living, seamlessly blending luxury, privacy, and nature with timeless elegance and high-quality materials.

The 28 private pool villas, set on plots ranging from 200 to 450 square wah, feature five distinct designs to suit diverse needs—from small families to retirees seeking a permanent holiday retreat.

Strategically located, The Pano benefits from the upcoming expressway, providing direct and convenient access to Phuket International Airport. The project also supports wellness-focused living, with 30 rai donated to Songkhla Nakarin University Hospital.

At The Pano, discover a lifestyle where privacy, nature, and exclusivity come together in perfect harmony.



Computer graphic generated for advertising purpose only, when completed that may differ from the image. The company reserves the right to change this information and details without prior notice

PROJECT INFORMATION

Project Name	THE PANO Baan Suan Loch Palm
Project Owner	Plan Estate Co., Ltd.
Location	Kathu, Phuket
Project Area	30-02-12.10 Rai
Project Description	Land & House 28 Plots - Land Area 199.30 - 457.20 Sq.w - House Area 350-550 Sq.m.
Saleable Area	9,446.30 Sq.w.
Common Area	2,765.80 Sq.w. (Pocket Park, Road and Others)
Maintenance Fee	Baht 35.00 per Sq.w.

PRICE LIST

Unit No.	Model	Land Area (Sq.w.)	Usable Area (Sq.m.)	Net Price	Booking 2%	Contract 28%	Transfer Payment
7	A	340.20	575.00	48,100,000	962,000	13,468,000	33,670,000
8	B	387.40	710.00	56,800,000	1,136,000	15,904,000	39,760,000
18	S	260.60	396.00	27,400,000	548,000	7,672,000	19,180,000

THE VAST NATURE WILL BE YOURS



Computer graphic generated for advertising purpose only. when completed that may different from the image. The company reserves the right to change this information and details without prior notice

MASTER PLAN



Public Park

Main Entrance

- 21 439.5 Sq.w. 1,758 Sq.m.
- 22 278.4 Sq.w. 1,113 Sq.m.
- 23 284.4 Sq.w. 1,137 Sq.m.
- 24 257.5 Sq.w. 1,137 Sq.m.
- 25 268.8 Sq.w. 1,075 Sq.m.
- 26 306 Sq.w. 1,224 Sq.m.
- 27 237.3 Sq.w. 949 Sq.m.
- 28
- 20 399.1 Sq.w. 1,596 Sq.m.
- 19 445.5 Sq.w. 1,782 Sq.m.
- 18 260.6 Sq.w. 1,042 Sq.m.
- 17 228.1 Sq.w. 912 Sq.m.
- 16 199.3 Sq.w. 797 Sq.m.
- 15 203.4 Sq.w. 813 Sq.m.
- 14 242.2 Sq.w. 968 Sq.m.
- 13 248.2 Sq.w. 992 Sq.m.
- 12 350 Sq.w. 1,402 Sq.m.
- 8 387.4 Sq.w. 1,549 Sq.m.
- 7 340.2 Sq.w. 1,360 Sq.m.
- 6 423.4 Sq.w. 1,693 Sq.m.
- 9 370 Sq.w. 1,480 Sq.m.
- 5 430.7 Sq.w. 1,722 Sq.m.
- 4 377.7 Sq.w. 1,510 Sq.m.
- 3 362.9 Sq.w. 1,451 Sq.m.
- 2 408.3 Sq.w. 1,633 Sq.m.
- 1 457.2 Sq.w. 1,828 Sq.m.
- 11 421.1 Sq.w. 1,684 Sq.m.
- 10 361.5 Sq.w. 1,446 Sq.m.

Computer graphic generated for advertising purpose only, when completed that may differ from the image. The company reserves the right to change this information and details without prior notice



Computer graphic generated for advertising purpose only, when completed that may differ from the image. The company reserves the right to change this information and details without prior notice

FROM LANDSCAPE TO UNIQUE DESIGN

The pano is a luxury home in Modern Tropical style, designed with emphasis on simple beauty, blending in with the surroundings, surrounded by peaceful nature, Among the unique cascading hills.

Pano House is designed under geometric shapes, maintaining the clarity of lines.
Gives a feeling of stability, solidity and reflects modernity.

NEARBY PLACES



- British International School 5.5 KM.
- Kajonkiet Sueksa (KS)/ International School (KIS) 8 KM.
- HeadStart Phuket 11 KM.



- Tesco Lotus Phuket 9 KM.
- Makro Phuket 9 KM.
- Central Phuket Festival & Central Foresta 9.5 KM.
- Big C Phuket 9.5 KM.
- Shopping Outlet Phuket 10 KM.



- Phuket Town 14 KM.
- Phuket International Airport 21 KM.



- Bangkok Hospital Siriroj 7 KM.
- Bangkok Hospital Phuket 8 KM.
- Dibuk Hospital 14 KM.



- Patong Beach 5.5 KM.
- Andamanda Phuket Water Park 9 KM.
- Karon Beach 10.5 KM.
- Kata Beach 10.5 KM.

GRAPHIC MAP

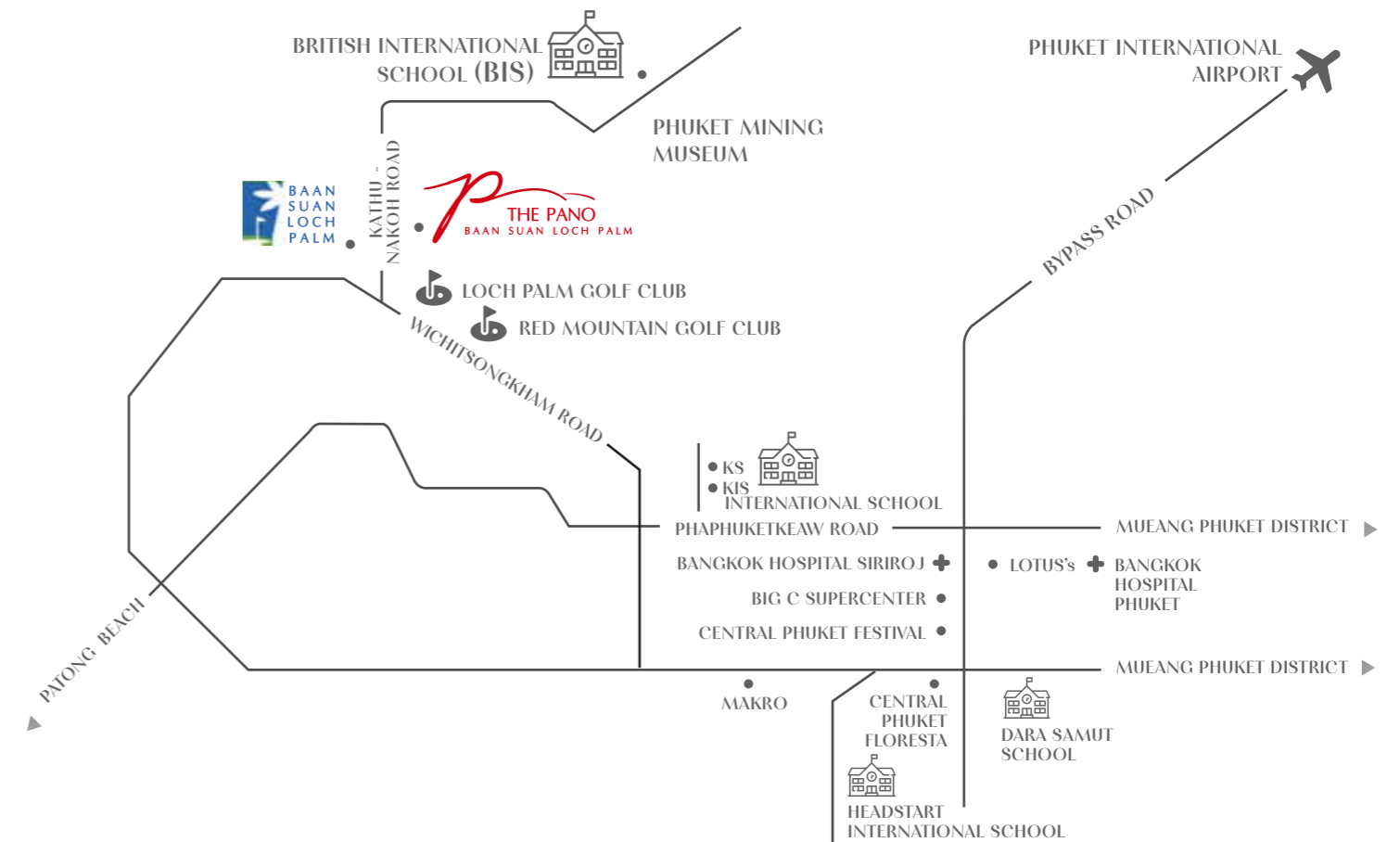

TYPE A

APPROXIMATE OF USABLE AREA : **575** SQ.M.

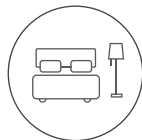

3 BEDROOM



3 BATHROOM



SWIMMING POOL
9 x 3 m..

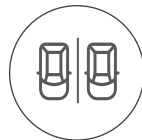

2 PARKING



Computer graphic generated for advertising purpose only. when completed that may differ from the image. The company reserves the right to change this information and details without prior notice

TYPE A : BACKYARD



Computer graphic generated for advertising purpose only. when completed that may differ from the image. The company reserves the right to change this information and details without prior notice

TYPE A : FRONTYARD



Computer graphic generated for advertising purpose only, when completed that may differ from the image. The company reserves the right to change this information and details without prior notice.

LIVING AREA



TYPE A : FLOOR PLAN

APPROXIMATE OF USABLE AREA : 575 SQ.M.

- | | | | | |
|--------------------|----------------|---------------|------------------|-----------------|
| 1 MASTER BEDROOM | 7 BEDROOM 1 | 12 PANTRY | 17 SUNKEN | 22 BATH MAID |
| 2 RELAXING AREA | 8 POWDER ROOM | 13 KITCHEN | 18 TERRACE | 23 STORAGE 2 |
| 3 WALK-IN-CLOSET | 9 WORKING ROOM | 14 STORAGE 1 | 19 PAVILION | 24 LAUNDRY AREA |
| 4 MASTER BATHROOM | 10 LIVING AREA | 15 BATHROOM 2 | 20 SWIMMING POOL | 25 PARKING |
| 5 BATHROOM 1 | 11 DINING AREA | 16 BEDROOM 2 | 21 MAID ROOM | 26 ENTRANCE |
| 6 WALK-IN-CLOSET 1 | | | | |

Computer graphic generated for advertising purpose only. when completed that may differ from the image. The company reserves the right to change this information and details without prior notice



Computer graphic generated for advertising purpose only, when completed that may differ from the image. The company reserves the right to change this information and details without prior notice.

MASTER BEDROOM

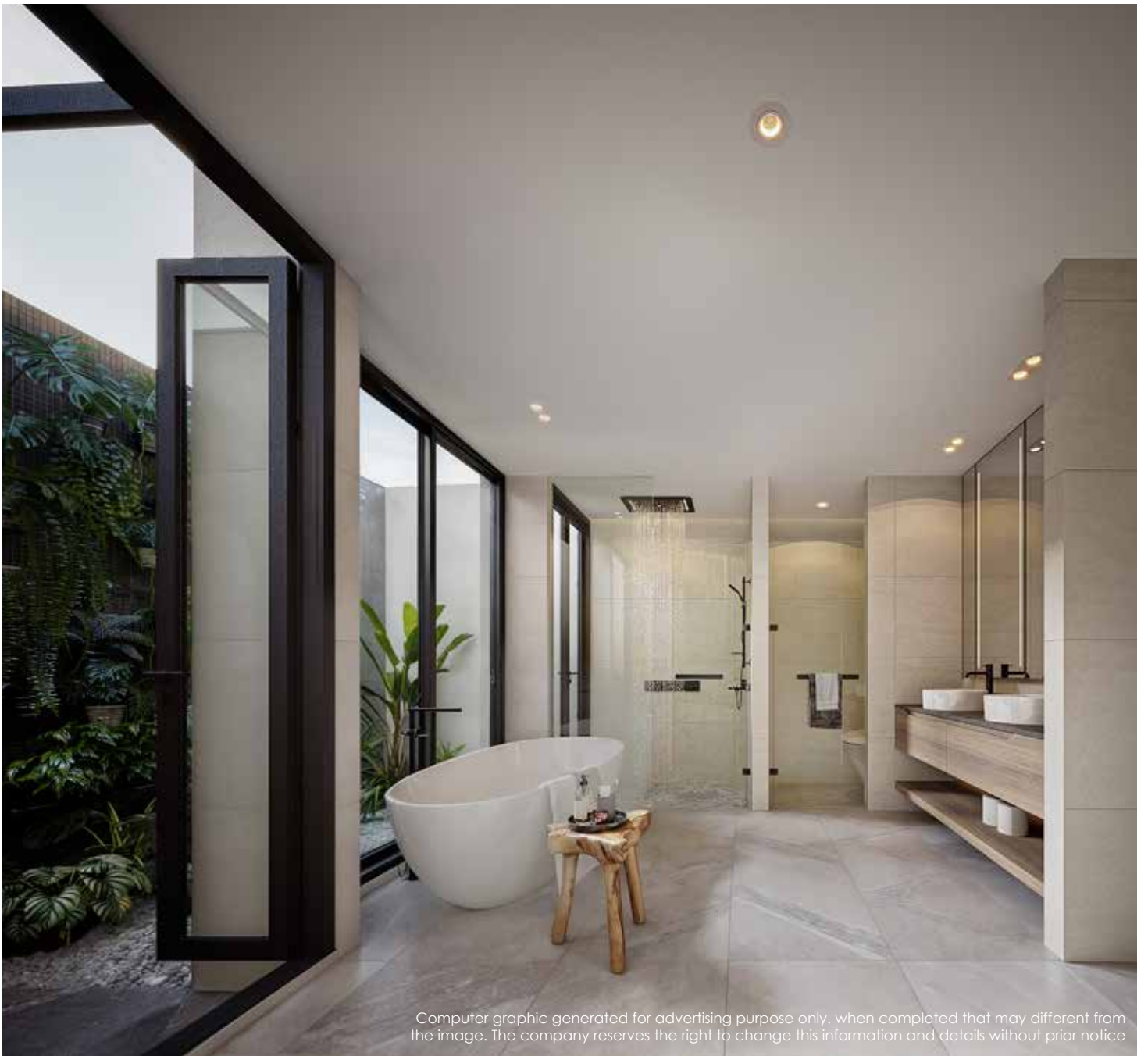

Computer graphic generated for advertising purpose only, when completed that may differ from the image. The company reserves the right to change this information and details without prior notice

MASTER BATHROOM

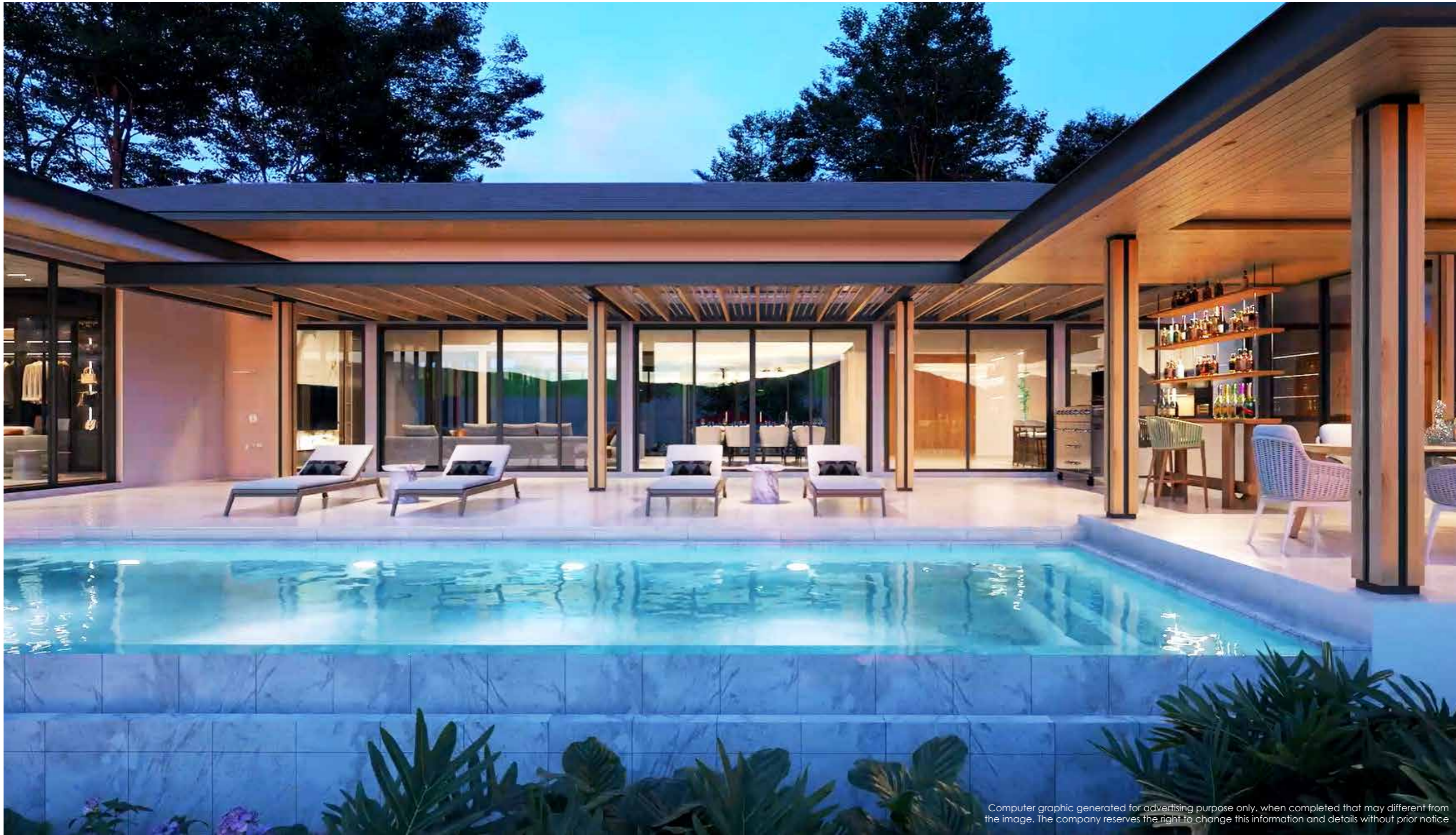

Computer graphic generated for advertising purpose only, when completed that may differ from the image. The company reserves the right to change this information and details without prior notice

TYPE B

APPROXIMATE OF USABLE AREA : **710** SQ.M.

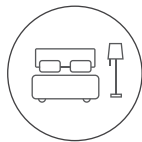

4 BEDROOM



4 BATHROOM



SWIMMING POOL
9 x 3 m.

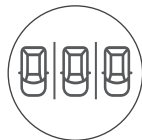

3 PARKING



Computer graphic generated for advertising purpose only, when completed that may differ from the image. The company reserves the right to change this information and details without prior notice.

TYPE B : BACKYARD



Computer graphic generated for advertising purpose only, when completed that may differ from the image. The company reserves the right to change this information and details without prior notice

TYPE B : FRONTYARD



TYPE B : FLOOR PLAN

APPROXIMATE OF USABLE AREA : 710.00 SQ.M.

- | | | | | |
|--------------------|----------------|--------------------------|---------------------|------------------|
| 1 BALCONY 1 | 8 BATHROOM 2 | 15 LIVING AREA | 21 WALK-IN-CLOSET 3 | 27 PUMP ROOM |
| 2 BEDROOM 1 | 9 WORKING ROOM | 16 MASTER BEDROOM | 22 BEDROOM 3 | 28 LAUNDRY AREA |
| 3 WALK-IN-CLOSET 1 | 10 BALCONY 3 | 17 RELAXING AREA | 23 ENTRANCE | 29 TERRACE |
| 4 BATHROOM 1 | 11 POWDER ROOM | 18 MASTER WALK-IN-CLOSET | 24 PARKING | 30 PAVILION |
| 5 BALCONY 2 | 12 KITCHEN | 19 MASTER BATHROOM | 25 MAID ROOM | 31 SWIMMING POOL |
| 6 BEDROOM 2 | 13 PANTRY | 20 BATHROOM 3 | 26 BATH MAID | |
| 7 WALK-IN-CLOSET 2 | 14 DINING AREA | | | |

Computer graphic generated for advertising purpose only. when completed that may differ from the image. The company reserves the right to change this information and details without prior notice



Computer graphic generated for advertising purpose only, when completed that may differ from the image. The company reserves the right to change this information and details without prior notice

LIVING AREA



Computer graphic generated for advertising purpose only, when completed that may differ from the image. The company reserves the right to change this information and details without prior notice

MASTER BEDROOM

TYPE C

APPROXIMATE OF USABLE AREA : **450** SQ.M.

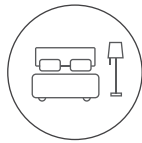

4 BEDROOM



4 BATHROOM



SWIMMING POOL
9 x 3 m.

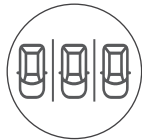

3 PARKING



Computer graphic generated for advertising purpose only. when completed that may differ from the image. The company reserves the right to change this information and details without prior notice

TYPE C : BACKYARD



Computer graphic generated for advertising purpose only. when completed that may differ from the image. The company reserves the right to change this information and details without prior notice

TYPE C : FRONTYARD



TYPE C : FLOOR PLAN

APPROXIMATE OF USABLE AREA : 450 SQ.M..

- | | | | | |
|--------------------|-------------------|--------------------------|---------------------|--------------|
| 1 BEDROOM 3 | 7 POWDER ROOM | 12 RELAXING AREA | 17 WALK-IN-CLOSET 2 | 22 STORAGE 2 |
| 2 WALK-IN-CLOSET 3 | 8 DINNING AREA | 13 MASTER WALK-IN-CLOSET | 18 ENTRANCE | 23 TOILET |
| 3 BATHROOM 3 | 9 PANTRY | 14 MASTER BATHROOM | 19 WALK WAY | 24 PUMP ROOM |
| 4 BEDROOM 4 | 10 LIVING AREA | 15 BATHROOM 2 | 20 STORAGE 1 | 25 SWIMMING |
| 5 WALK-IN-CLOSET 3 | 11 MASTER BEDROOM | 16 BEDROOM 2 | 21 STATION | 26 TERRACE |
| 6 BATHROOM 4 | | | | |

Computer graphic generated for advertising purpose only. when completed that may differ from the image. The company reserves the right to change this information and details without prior notice

TYPE D

APPROXIMATE OF USABLE AREA : **350** SQ.M.

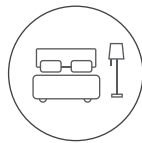

3 BEDROOM



3 BATHROOM



SWIMMING POOL
9 x 3 m.



2 PARKING



TYPE D : BACKYARD



Computer graphic generated for advertising purpose only, when completed that may differ from the image. The company reserves the right to change this information and details without prior notice

TYPE D : FRONTYARD

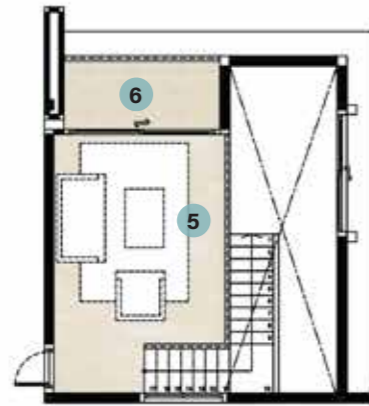

UPPER



TYPE D : FLOOR PLAN

APPROXIMATE OF USABLE AREA : 350..00 SQ.M.

- | | | | | |
|--------------------|-------------------|--------------------------|---------------------|------------------|
| 1 BEDROOM 3 | 6 BALCONY | 11 MASTER WALK-IN-CLOSET | 16 POWDER ROOM | 21 BATHROOM 1 |
| 2 WALK-IN-CLOSET 3 | 7 DINNING AREA | 12 MASTER BATHROOM | 17 ENTRANCE | 22 TERRACE |
| 3 BATHROOM 3 | 8 PANTRY | 13 STORAGE 1 | 18 WALK WAY | 23 SWIMMING POOL |
| 4 UP STAIRS | 9 LIVING AREA | 14 STORAGE 2 | 19 BEDROOM 1 | 24 STORE |
| 5 MULTI AREA | 10 MASTER BEDROOM | 15 LAUNDRY AREA | 20 WALK-IN-CLOSET 1 | 25 PARKING |

TYPE E

APPROXIMATE OF USABLE AREA : **550** SQ.M.

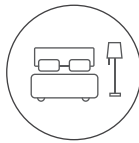

4 BEDROOM



4 BATHROOM



SWIMMING POOL
9 x 3 m.

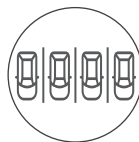

4 PARKING



Computer graphic generated for advertising purpose only, when completed that may differ from the image. The company reserves the right to change this information and details without prior notice

TYPE E : BACKYARD



TYPE E : FRONTYARD



TYPE E : FLOOR PLAN

APPROXIMATE OF USABLE AREA : 550 SQ.M.

- | | | | | |
|---------------------------|----------------------------|----------------------|------------------|------------------|
| 1 MASTER BEDROOM 2 | 7 BATHROOM 3 | 13 MASTER BATHROOM 1 | 19 WALK WAY | 25 STORAGE /SN |
| 2 MASTER WALK-IN-CLOSET 2 | 8 DINNING AREA | 14 POWDER ROOM | 20 SEAT | 26 STORAGE /EE |
| 3 MASTER BATHROOM 2 | 9 PANTRY | 15 BEDROOM 4 | 21 STORE | 27 SWIMMING POOL |
| 4 WALK WAY | 10 LIVING AREA | 16 WALK-IN-CLOSET 4 | 22 MAID ROOM | 28 TERRACE |
| 5 BEDROOM 3 | 11 MASTER BEDROOM 1 | 17 BATHROOM 4 | 23 LAUNDRY AREA | 29 PARKING |
| 6 WALK-IN-CLOSET 3 | 12 MASTER WALK-IN-CLOSET 1 | 18 ENTRANCE | 24 MAID BATHROOM | |

Computer graphic generated for advertising purpose only. when completed that may differ from the image. The company reserves the right to change this information and details without prior notice

CONTACT US

Sales Office

The Pano Baan Suan Loch Palm

Open Daily : 09.00 am. - 05.00 pm.

Email : salesphuket@mbkasl.co.th

Tel : 081 - 917-1813, 089 - 204 - 6949



THE PANO BAAN SUAN LOCH PALM PROJECT OWNER : PLAN ESTATE CO.,LTD CAPITAL : BAHT 200 MILLION (BAHT 200 MILLION ALREADY PAID.) BRANCH OFFICE 59/5 ROOM NUMBER 3A02 - 1 3RD FLOOR, PARADISE PLACE BUILDING, SRINAGARINDRA ROAD, NONG BON, PRAWET, BANGKOK 10250 AUTHORIZED PERSON : MR. KASEMSUK CHONGMANKONG, MR.THEERA WONGSAWANON LOCATION : KATHU - KOHKAEW ROAD, KATHU SUB DISTRICT, PHUKET TITLE DEED : 7186, 9326, 11155 TOTAL LAND SIZE IS 30 - 2 - 12.1 RAI THE LAND DOES NOT HAVE ANY ENCUMBRANCES OR MORGAGE WITH A BANK CONSTRUCTION STARTED JAN, 2024 EXPECTED COMPLETION 2028 TRANSFER OWNERSHIP WITHIN 60 DAYS AFTER FULL PAYMENT ACCORDING TO THE CONTRACT.

COMPUTER GRAPHIC GENERATED FOR ADVERTISING PURPOSE ONLY. WHEN COMPLETED THAT MAY DIFFERENT FROM THE IMAGE. THE COMPANY RESERVES THE RIGHT TO CHANGE THIS INFORMATION AND DETAILS WITHOUT PRIOR NOTICE